

Secondary Screening – No sites adequate to accommodate a waste transfer station were found.

M1 Area 5 - Area is bordered by R6 district to the east and falls entirely within a 400' buffer of this sensitive receptor.

M1 Area 6 - Note: This area is primarily within Brooklyn CD #8 and is assessed in that section.

M1 Area 7 - Area is surrounded by residential districts and within the 400' buffer of these sensitive receptors.

Brooklyn Community District #3 (0 transfer stations)

400' Buffer to sensitive receptors; 400' buffer between transfer stations

M1 District 1 – Note: Portions of this M1 district are in Brooklyn CD#1 and CD#3. The portion contained within Brooklyn CD#1 will not be assessed, as new waste transfer stations would not be permitted in M1 zones in that Community District under the proposed rules. The portion within Brooklyn CD#2 will be assessed in this section.

This M1 district is for the most part surrounded by residential districts, with the exception of the portion that borders the Brooklyn Navy Yard, which is an M3 district. In this part of the M1 district, all but the half block directly adjacent to the Navy Yard is excluded by residential buffers. East of the Brooklyn Queens Expressway, a slightly wider portion remains under consideration, encompassing most of the blocks between Flushing Ave. and Park Ave. South of Park Ave., only a narrow area is not subject to residential buffers.

Secondary Screening – No appropriate sites were identified west of the Brooklyn-Queens Expressway. East of the expressway, there is a lot just south of Flushing Ave between Franklin Ave and Skillman Street that is large enough to accommodate a waste transfer station. However, it is within a 400' buffer of a school, so cannot be considered. Between Bedford Ave and Spencer St., midblock between Park Ave and Flushing Ave, there are several unoccupied lots that taken together could provide enough space for a waste transfer station. This site appears to be just out of the reach of a 400' buffer from a nearby school. Almost directly south of this, on Spenser St. between Park and Myrtle Aves, there is a similar conglomeration of empty lots. However, taken together they do not appear to be large enough to allow a waste transfer station to locate there. Of the above sites, only one appears to be large enough for siting a waste transfer station. Therefore, the proximate siting of more than one waste transfer station is not possible.

M1 Area 2 - Area is surrounded by residential districts and within the 400' buffer of these sensitive receptors.

Brooklyn Community District 2

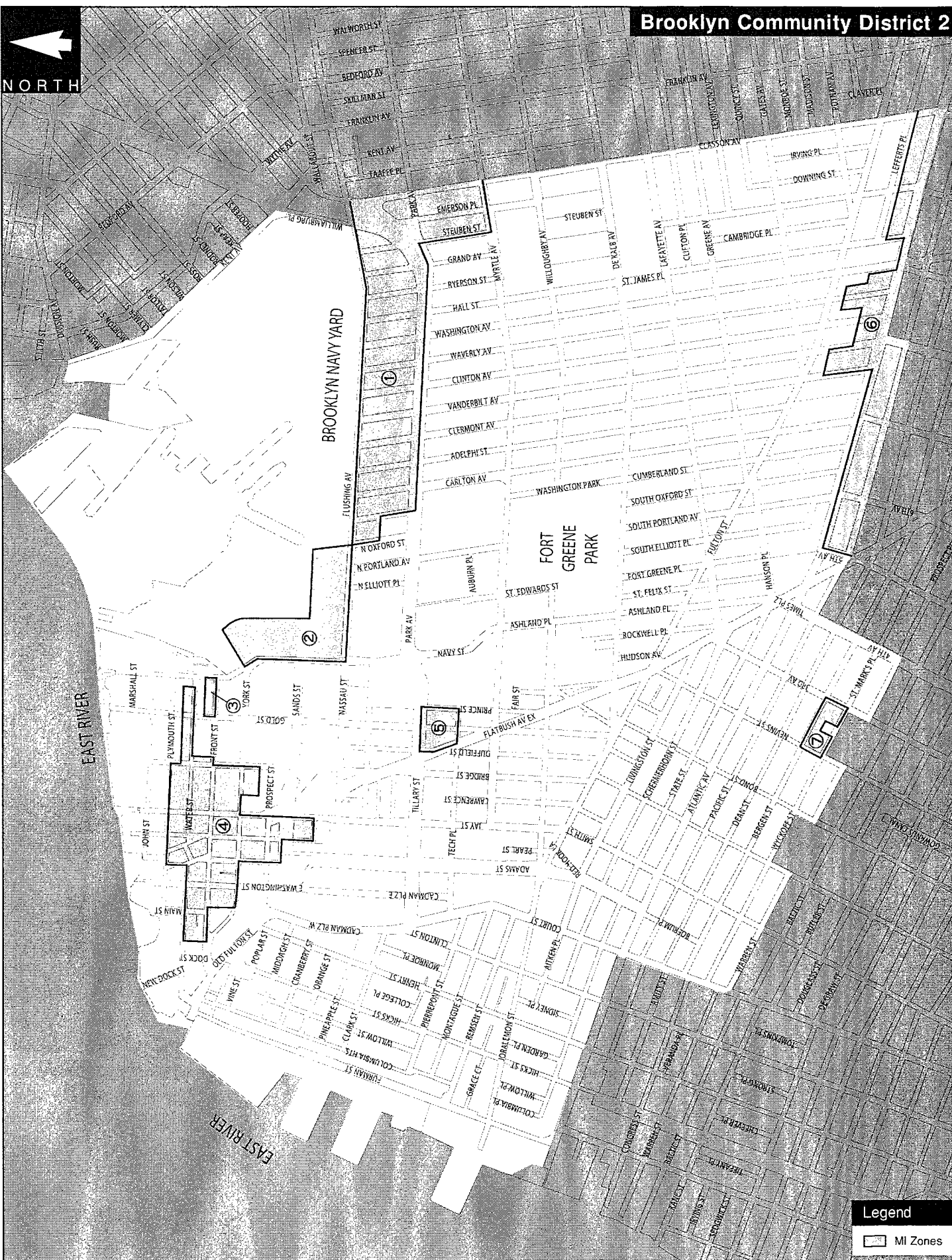

Legend

 MI Zones

Brooklyn Community District 3

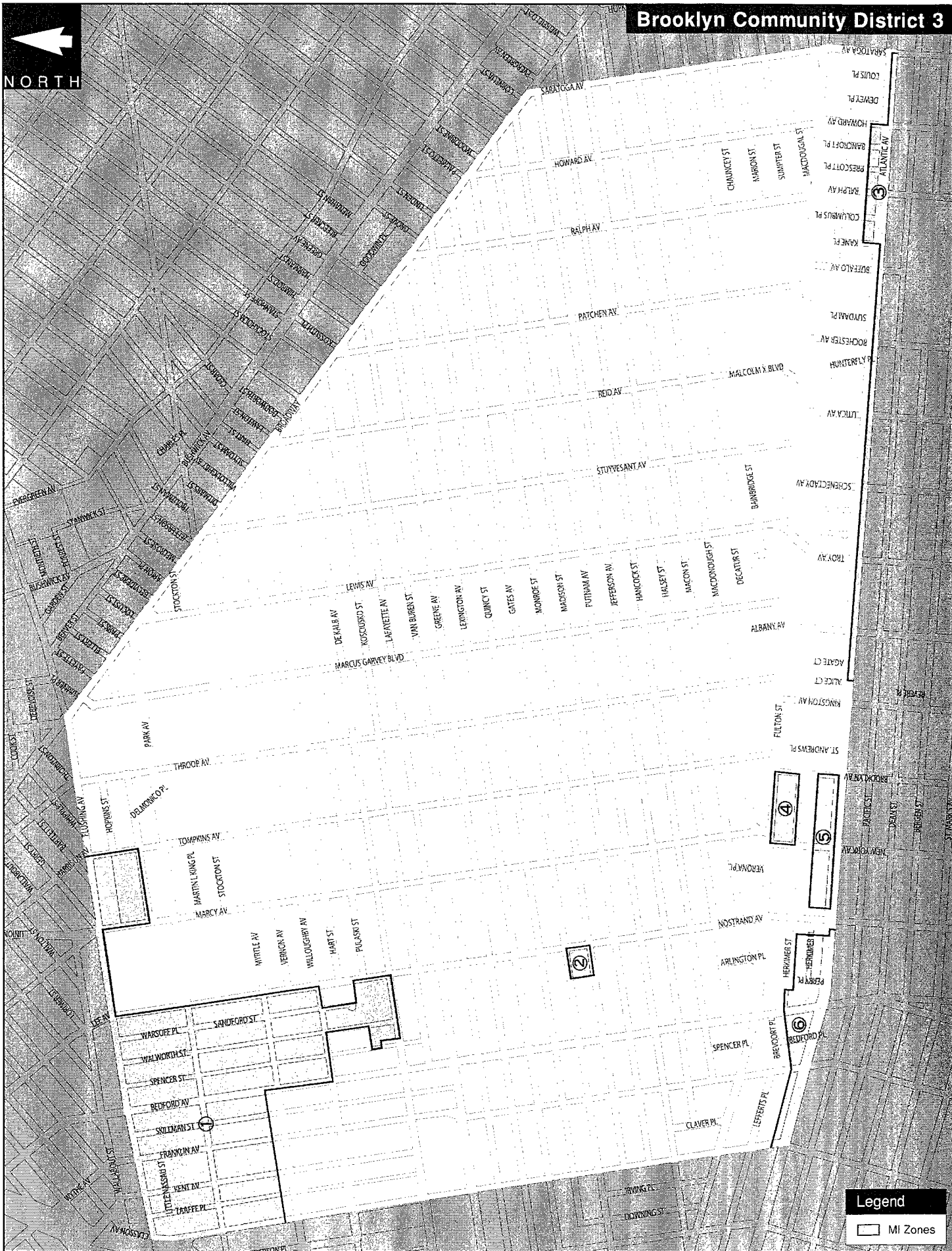

Legend

 MI Zones

M1 Area 3 - Note: This area is primarily within Brooklyn CD #8 and is assessed in that section.

M1 Area 4 - Area is surrounded by residential districts and within the 400' buffer of these sensitive receptors.

M1 Area 5 - Area is surrounded by residential districts and within the 400' buffer of these sensitive receptors.

M1 Area 6- Note: This area is primarily within Brooklyn CD #8 and is assessed in that section.

Brooklyn Community District #4 (0 transfer stations)

400' Buffer to sensitive receptors; 400' buffer between transfer stations

M1 Area 1- Note: This M1 area extends into Queens CD #5 and is assessed in that section.

M1 Area 2 - Note: This M1 area extends into Queens CD #5 and is assessed in that section.

M1 Area 3 - Note: This M1 area extends into Brooklyn CD #16 and is assessed in that section.

Brooklyn Community District #5 (2 transfer stations)

400' Buffer to sensitive receptors; 400' buffer between transfer stations

Brooklyn Community District #5 already has two waste transfer stations within M1 area 9, and under the proposed siting rules only one more can be added. Therefore, the proximate siting of more than one waste transfer station is only possible in M1 area 9 (one new waste transfer station plus two existing stations) and only that area will be evaluated.

M1 Area 9 – This M1 Area is for the most part surrounded by residential zones. Due to the 400' buffer imposed by these zones, the perimeter of the M1 district is not available for waste transfer station siting. In addition, no new waste transfer station can be located within a 400' buffer of the existing waste transfer stations. This eliminates additional land in the northwest part of the M1 district. What remains is the area between Cozine Ave, Logan Street, Wortman Ave, and Essex Street, and a few additional blocks to the north and south of this area. This area will be assessed below.

Secondary Screening – Just below Cozine Ave, on the east side of Milford St, there is a paved block. The eastern half of this block is within the 400’ buffer from the nearby residential district. Therefore, this site was eliminated from consideration. No other potential sites were identified.

Brooklyn Community District #6 (2 transfer stations)

400’ Buffer to sensitive receptors; 400’ buffer between transfer stations

M1 Area 1- To the south and west of this M1 area are residential zones, which impose a 400’ buffer on it. In addition, a playground between St. John’s Place and Lincoln Place eliminate from consideration any land north of Sackett Street. This leaves a relatively small area along Third Avenue that may be considered for waste transfer station siting.

Secondary Screening – No appropriate sites for waste transfer stations were identified within the eligible area; therefore, the proximate siting of more than one waste transfer station is not a possibility in this M1 district.

M1 Area 2 - Area is surrounded by residential districts and within the 400’ buffer of these sensitive receptors.

M1 Area 3 - Area is surrounded by residential districts and within the 400’ buffer of these sensitive receptors.

M1 Area 4- Area is surrounded by residential districts and within the 400’ buffer of these sensitive receptors.

M1 Area 5 - Area is surrounded by residential districts and within the 400’ buffer of these sensitive receptors.

M1 Area 6 – Area is too small for the proximate siting of more than one waste transfer station to occur.

M1 Area 7 - Area is bordered by residential districts on its north and west and falls entirely within the 400’ buffer of those districts. There is also an existing waste transfer station in this M1 district.

M1 Area 8 – This M1 area has residential districts on its south and east sides. The 400’ buffer from these residential districts eliminates much of the area, leaving only a triangle-shaped area of land eligible for waste transfer station siting between Hamilton Ave and Commerce St., which is assessed below.

Secondary Screening – A playground above the Battery Tunnel entrance reduces the potential area of eligibility even further with its 400’ buffer. No appropriate sites were found for waste transfer stations within the remaining area.

Brooklyn Community District 4

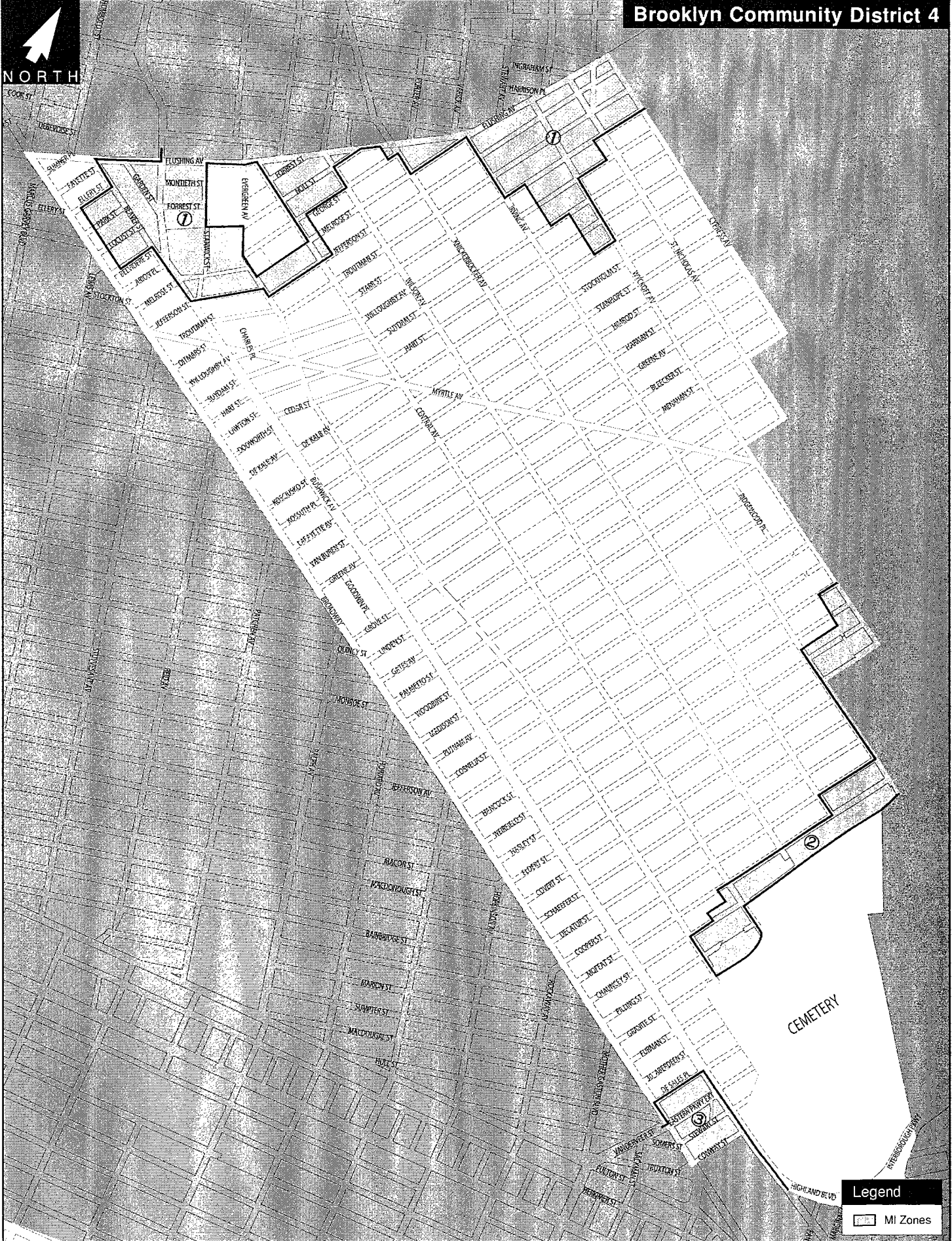

NORTH

CEMETERY

Legend
MI Zones

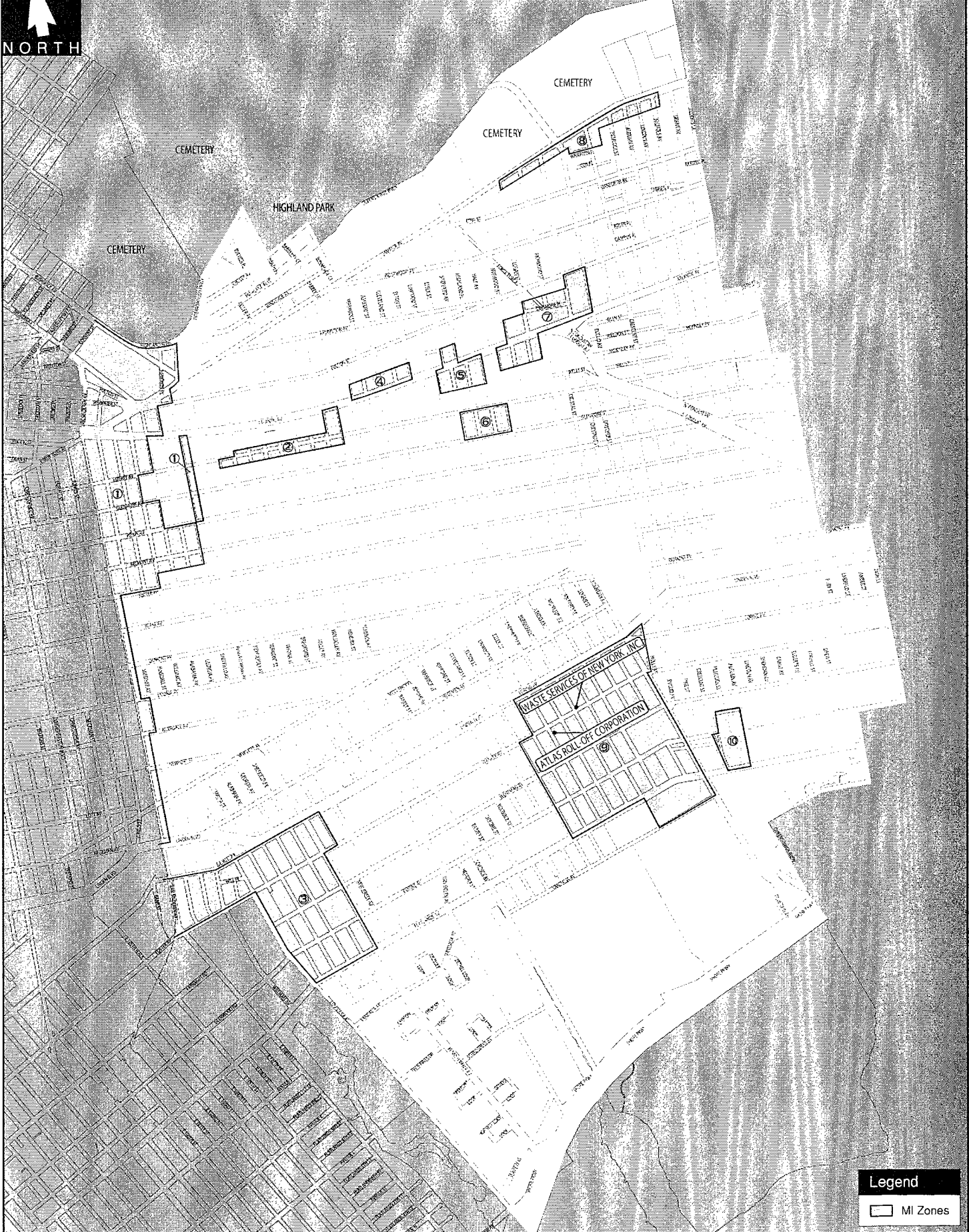

Legend

□ MI Zones



NORTH

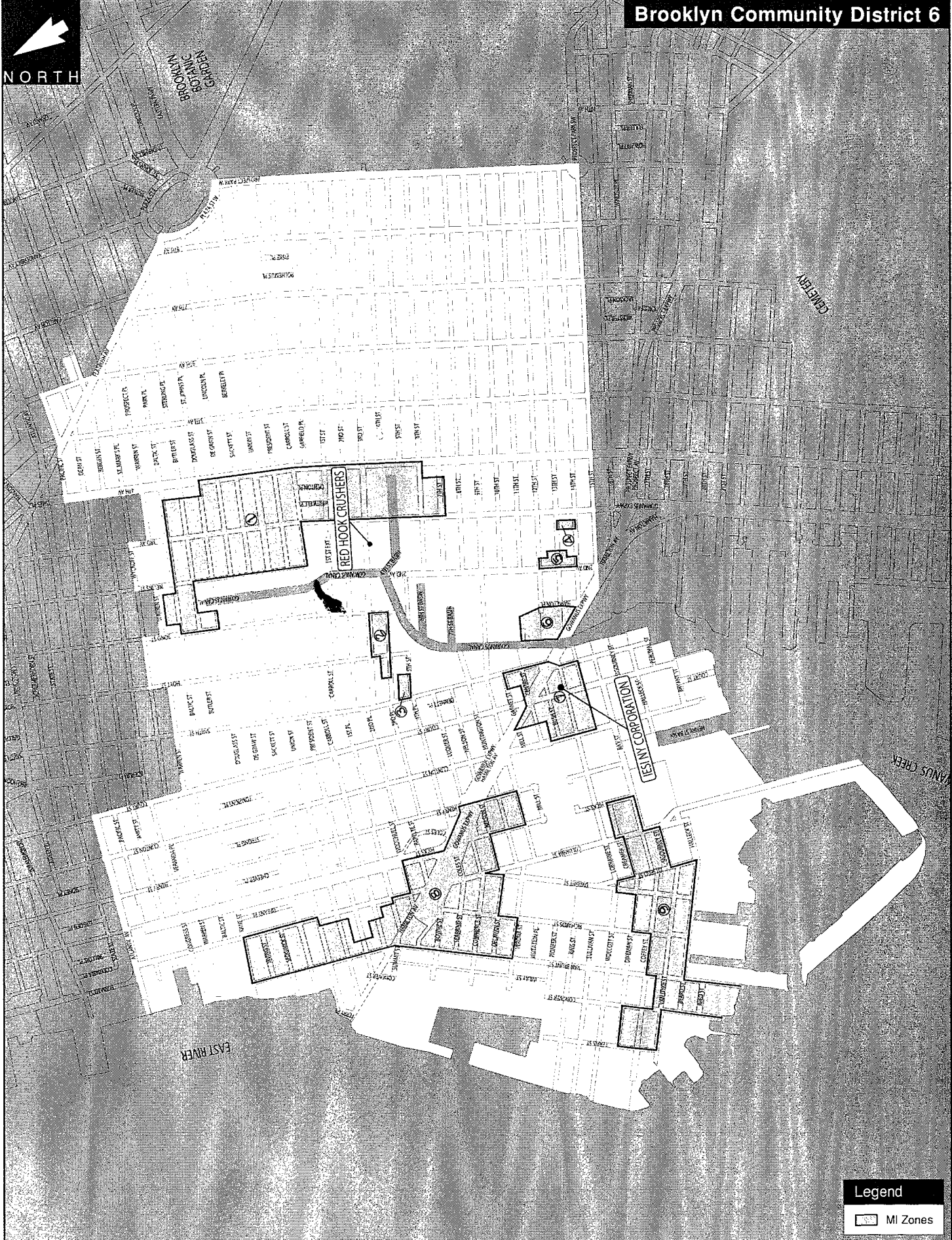

Legend

-  MI Zones

M1 Area 9 – This M1 district has residential districts to its north and west. These residential districts create 400’ buffers that eliminate most of the land in the M1 district from consideration. Three small areas remain under consideration, including the blocks south of Beard Street between Conover and Brunt Streets.

Secondary Screening – There appear to be underutilized and/or vacant sites both north and south of Reed Street between Conover and Brunt Streets. Either of these sites would be large enough to accommodate a waste transfer station. No other appropriate sites were identified. No proximate siting of more than one waste transfer station is possible, because the two sites mentioned above are too close to one another to allow for the transfer station use of both of them without violating the 400’ buffer required between such facilities.

Brooklyn Community District #7 (1 transfer station)

400’ Buffer to sensitive receptors; 400’ buffer between transfer stations

M1 Area 1 – Note: This M1 district extends into Brooklyn CD#12. The M1 district will be assessed in its entirety in this section.

It is helpful to divide this long M1 district into three parts, a northern, southern, and eastern sub-area. The northern sub area extends from the Prospect Expressway south to 37th Street , and is bordered by a residential zone to the east. The buffer from this residential zone extends 400’ into the M1 district, and as a result only the western half of the blocks between 3rd and 4th Avenues are available for waste transfer station sitings, with the exception of a section between 26th and 27th Streets that extends a little bit to the east. The southern sub area runs from 37th Street down to 54th Street, in between 2nd and 3rd Avenues. It also has residential districts to the east, which also impose a buffer and leave only the western half of blocks available for siting. The eastern sub area runs from 3rd Avenue east to 15th Ave. for the most part in between 37th and 40th street. Only the blocks north of 38th street fall outside the buffer of the residential zoning district to the south.

Secondary Screening

Northern Sub-area - On the south side of 26th street, east of 4th Avenue, there is an underutilized lot used for vehicle storage. However, the lot appears to be less than 20,000 Square feet and would not be adequate for a waste transfer station. Between 28th and 29th Street, the western half of the block between 3rd and 4th Avenues is vacant, and there is enough room for a waste transfer station. No other potential waste transfer station sites were identified in this sub-area.

Southern Sub-area – At the northern part of this sub-area, a large block between 37th and 39th streets is undeveloped and unoccupied. A waste transfer station could easily fit on this block. No other appropriate sites were identified.

The two potential sites identified, one in the northern sub-area and one in the southern sub-area, are significantly farther apart from one another than ¼ mile. Even if waste transfer stations were developed in both locations, they would not be close enough to each other to have potential cumulative effects.

Eastern Sub-area – This area is occupied by New York City Transit's 36-38 Street Subway Yard, and therefore would not be a feasible site for a transfer station.

M1 Area 2 – Area is surrounded by residential districts and within the 400' buffer of these sensitive receptors.

M1 Area 3 - Area is surrounded by residential districts on three sides and within the 400' buffer of these sensitive receptors.

M1 Area 4 - Area is too small for the proximate siting of more than one waste transfer station to occur.

M1 Area 5 - Area is too small for the proximate siting of more than one waste transfer station to occur. ➤

M1 Area 6 – Note: M1 Area is primarily in Brooklyn CD#12 and is assessed under that Community District section.

Brooklyn Community District #8 (0 transfer stations)

400' Buffer to sensitive receptors; 400' buffer between transfer stations.

M1 Area 1 – This area is surrounded on all sides by residential districts, with the exception of a small area on its east end. As such, it is too narrow to support the siting of a waste transfer station.

M1 Area 2 – This area is surrounded on all sides by residential districts. Thus, it is not wide enough to support the siting of a waste transfer station.

