



---

**IN THE MATTER OF** an application, submitted by The New York City Department of Environmental Protection and the New York City Department of Small Business Services pursuant to Sections 197-c and 199 of the New York City Charter, and Section 5-430 *et seq.* of the New York City Administrative Code for an amendment to the City Map involving:

- the elimination, discontinuance and closing of a portion of marginal street, wharf or place east of Whale Creek Canal;
- the establishment of a cul-de-sac in Kingsland Avenue north of Greenpoint Avenue;
- the narrowing of Whale Creek Canal; and
- the adjustment of grades and block dimensions necessitated thereby;

including authorization for any acquisition or disposition of real property related thereto, in Community District 1, Borough of Brooklyn, in accordance with Map Nos. Z-2742 and X-2747 dated May 31, 2016 and signed by the Borough President.

---

This application for an amendment to the City Map was filed by The New York City Department of Environmental Protection and The Department of Small Business Services on December 1, 2011. The proposed City Map amendment, along with its related action, would facilitate the Newtown Creek Nature Walk Phase III extension in the Greenpoint neighborhood of Brooklyn, Community District 1.

### **RELATED ACTIONS**

In addition to the amendment to the City Map (C 120120 MMK) which is the subject of this report, implementation of the proposed development also requires action by the City Planning Commission on the following application which is being considered concurrently with this application:

C 160243 PSK            Proposed site selection of property in the demapped bed of Marginal Street Kingsland Avenue.

## **BACKGROUND**

A full background discussion and description of this application appears in the report for the related site selection action (C 160243 PSK).

## **ENVIRONMENTAL REVIEW**

This application (C 120120 MMK), in conjunction with the related application (C 160243 PSK), was reviewed pursuant to the New York State Environmental Quality Review Act (SEQRA), and the SEQRA regulations set forth in Volume 6 of the New York Code of Rules and Regulations, Section 617.00 *et seq.* and the City Environmental Quality Review (CEQR) Rules of Procedure of 1991 and Executive Order No. 91 of 1977. The lead is the Department of Environmental Protection. The designated CEQR number is 11DEP036K.

A summary of the environmental review appears in the report for the related site selection action (C 160243 PSK).

## **UNIFORM LAND USE REVIEW**

This application (C 120120 MMK) in conjunction with the application for the related action (C 160243 PSK) was certified as complete by the Department of City Planning on July 11, 2016, and was duly referred to Brooklyn Community Board 1 and the Borough President, in accordance with Title 62 of the Rules of the City of New York, Section 2-02(b).

## **COMMUNITY BOARD PUBLIC HEARING**

Community Board 1 held a public hearing on this action on August 9, 2016 and on September 14, 2016, by a vote of 34 in favor, 0 opposed, and none abstaining, the Board adopted a resolution recommending approval of the application with conditions.

A summary of the recommendation and conditions of Community Board 1 appears in the report for the related site selection action (C 160243 PSK).

### **BOROUGH PRESIDENT RECOMMENDATION**

This application (C 120120 MMK) was considered by the Borough President of Brooklyn, who on October 19, 2016 issued a recommendation approving the application, with conditions.

A summary of the recommendation and conditions of the Borough President appears in the report for the related site selection action (C 160243 PSK).

### **CITY PLANNING COMMISSION PUBLIC HEARING**

On October 19, 2016 (Calendar No. 2), the City Planning Commission scheduled November 2, 2016, for a public hearing on this application (C 120120 MMK). The hearing was duly held on November 2, 2016 (Calendar No. 12), in conjunction with the public hearing on the related action.

There was one appearance, as described in the report for the related site selection action (C 160243 PSK) and the hearing was closed.

### **WATERFRONT REVITALIZATION PROGRAM CONSISTENCY REVIEW**

This application (C 120120 MMK) in conjunction with the application for the related action (C 160243 PSK) was reviewed by the City Coastal Commission for consistency with the policies of the New York City Waterfront Revitalization Program (WRP), as amended, approved by the New York City Council on October 30, 2013 and by the New York State Department of State on February 3, 2016, pursuant to the New York State Waterfront Revitalization and Coastal Resources Act of 1981, (New York State Executive Law, Section 910 *et seq.*) The designated WRP number is 13-140.

This action was determined to be consistent with the policies of the New York City Waterfront Revitalization Program.

## **CONSIDERATION**

The Commission believes that this application for a City Map amendment (C 120120 MMK) is appropriate.

A full consideration and analysis of the issues, and the reasons for approving this application, appear in the report for the related site selection action (C 160243 PSK).

## **RESOLUTION**

Therefore, the City Planning Commission, deeming the proposed amendment to the City Map and any related acquisition or disposition of real property related thereto to be appropriate, adopts the following resolution:

**RESOLVED**, that the City Planning Commission finds that the action described herein will have no significant impact on the environment; and be it further

**RESOLVED**, the City Coastal Commission finds that the action will not substantially hinder the achievement of any WRP policy and hereby determines that this action is consistent with WRP policies; and be it further

**RESOLVED**, by the City Planning Commission, pursuant to Sections 197-c and 199 of the New York City Charter, and Section 5-430 et seq. of the New York City Administrative Code that based on the environmental determination and the consideration described in this report, the application (C 120120 MMK), for an amendment to the City Map involving:

- the elimination, discontinuance and closing of a portion of marginal street, wharf or place east of Whale Creek Canal (such Marginal Street, Wharf or Place, where the same is shown on any existing plans for the waterfront or portion thereof, shall be incorporated, as modified herein, into the City Map, in accordance with Section 1302(a) of the New York City Charter);

- the establishment of a cul-de-sac in Kingsland Avenue north of Greenpoint Avenue;
- the narrowing of Whale Creek Canal; and
- the adjustment of grades and block dimensions necessitated thereby;

including authorization for any acquisition or disposition of real property related thereto, in Community District 1, Borough of Brooklyn, in accordance with Map Nos. Z-2742 and X-2747 dated May 31, 2016 and signed by the Borough President.; and be it further

**RESOLVED** that, pursuant to Section 5-432 of the New York City Administrative Code, the City Planning Commission determines that “such closing or discontinuance will further the health, safety, pedestrian or vehicular circulation, housing, economic development or general welfare of the City”; and be it further

**RESOLVED** that, pursuant to Section 5-433 of the New York City Administrative Code, the City Planning Commission adopts the legally required number of counterparts of Map Nos. Z-2742 and X-2747 dated May 31, 2016 providing for the discontinuance and closing of Kingsland Avenue between Whale Creek Canal and the intersection of North Henry Street and Marginal Street, Wharf or Place more particularly described as follows:

**PARCEL A**

**DISCONTINUING AND CLOSING A PORTION OF KINGSLAND AVENUE  
MARGINAL STREET, WHARF OR PLACE LOCATED BETWEEN WHALE CREEK  
CANAL ON THE WESTERLY SIDE, AND THE SOUTHWESTERLY  
PROLONGATION OF THE NORTHWESTERLY LINE OF NORTH HENRY STREET  
MARGINAL STREET, WHARF OR PLACE AND THE NORTHWESTERLY  
PROLONGATION OF THE NEWLY ESTABLISHED SOUTHWESTERLY STREET  
LINE OF KINGSLAND AVENUE ON THE EASTERLY SIDE.**

In the matter of discontinuing and closing Kingsland Avenue Marginal Street, Wharf or Place, Borough of Brooklyn, County of Kings, City and State of New York, in accordance with Borough President Map No. X-2747:

Starting at a point located at the intersection of Kingsland Avenue Marginal Street, Wharf or Place, discontinued and closed, with the easterly boundary line of Whale Creek Canal as hereinbefore laid out on the City Map;

- 1) Running thence easterly, along said northerly street line of Kingsland Avenue Marginal Street, Wharf or Place, discontinued and closed, 361.63 feet to its intersection with the northwesterly line of North Henry Street Marginal Street, Wharf or Place;
- 2) Running thence southwesterly, along the prolongation of the northwesterly line of North Henry Street Marginal Street, Wharf or Place, said course forming a deflection angle to the right, with the last mentioned course, of 119 degrees 56 minutes 32 seconds, 22.09 feet to its intersection with the newly established northwesterly street line of Kingsland Avenue;
- 3) Running thence southeasterly, along said newly established southwesterly street line of Kingsland Avenue, said course forming a deflection angle to the left with the last mentioned course, of 74 degrees 55 minutes 41 seconds, 114.32 feet to its intersection with the southerly line of Kingsland Avenue Marginal Street, Wharf or Place, discontinued and closed;
- 4) Running thence westerly, along said southerly line of Kingsland Avenue Marginal Street, Wharf or Place, discontinued and closed, said course forming a deflection angle to the right with the last mentioned course, of 134 degrees 59 minutes 09 seconds, 431.39 feet to a point on the easterly line of Whale Creek Canal;
- 5) Running thence northerly, along said easterly line of Whale Creek Canal, said course forming a deflection angle to the right with the last mentioned course, of 89 degrees 58 minutes 52 seconds, 100.00 feet to the Point or Place of Beginning.

The area described above consists of 38,431 square feet, more or less, located in Section 9 of the Kings County Land Map.

**PARCEL B**

**DISCONTINUING AND CLOSING A PORTION OF NORTH HENRY STREET  
MARGINAL STREET, WHARF OR PLACE LOCATED BETWEEN KINGSLAND  
AVENUE AND KINGSLAND AVENUE MARGINAL STREET, WHARF OR PLACE.**

In the matter of discontinuing and closing a portion North Henry Street Marginal Street, Wharf or Place, Borough of Brooklyn, County of Kings, City and State of New York, in accordance with Borough President Map No. X-2747:

Starting at a point located at the intersection of the northerly side of North Henry Street Marginal Street, Wharf or Place, and Kingsland Avenue Marginal Street, Wharf or Place, discontinued and closed;

- 1) Running thence northeasterly, along said northerly line of North Henry Street Marginal Street, or Place, discontinued and closed, said course being coterminous with the newly established Kingsland Avenue, 100.00 feet, to a point;
- 2) Running thence southeasterly, along the northwesterly line of North Henry Street Marginal Street, Wharf or Place, discontinued and closed, said course being coterminous with the newly established Kingsland Avenue, said course also forming a deflection angle to the right with the last mentioned course, of 90 degrees 00 minutes 00 seconds, 100.00 feet to its intersection with the southeasterly line of North Henry Street Marginal Street, Wharf or Place;
- 3) Running thence southwesterly, along said southeasterly line of North Henry Street Marginal Street, Wharf or Place, discontinued and closed, said course being coterminous with the newly established Kingsland Avenue, said course also forming a deflection angle to the right with the last mentioned course, of 90 degrees 00 minutes 00 seconds, 51.67 feet to a point and the intersection of the southeasterly side of North Henry Street Marginal Street, Wharf or Place, discontinued and closed, and the newly established northeasterly street line of Kingsland Avenue;

- 4) Running thence southerly, along said line of North Henry Street Marginal Street, Wharf or Place, discontinued and closed, and perpendicular with the Kingsland Avenue Marginal Street, Wharf or Place, discontinued and closed, said course forming a deflection angle to the left with the last mentioned course, of 29 degrees 56 minutes 32 seconds, 91.97 feet to the intersection of the prolongation of the southerly line of Kingsland Avenue Marginal Street, Wharf or Place, discontinued and closed;
- 5) Running thence westerly along said southerly line of Kingsland Avenue Marginal Street, Wharf or Place, discontinued and closed, said course forming a deflection angle to the right with the last mentioned course of 90 degrees 00 minutes 00 seconds, 40.98 feet to the southwesterly line of Kingsland Avenue Marginal Street, Wharf or Place, discontinued and closed;
- 6) Running thence northwesterly along said Kingsland Avenue Marginal Street, Wharf or Place, discontinued and closed, said course forming a deflection angle to the right with the last mentioned course, of 45 degrees 00 minutes 51 seconds, 114.32 feet to the prolongation of the westerly line of North Henry Street Marginal Street, Wharf or Place;
- 7) Running thence northeasterly along the westerly line of North Henry Street Marginal Street, Wharf or Place, discontinued and closed, said course forming a deflection angle to the right with the last mentioned course, of 74 degrees 55 minutes 41 seconds, 22.09 feet to the Point or Place of Beginning.

The area described above consists of 15,946 square feet, more or less, located in Section 9 of the Kings County Land Map.

All such approvals being subject to the following conditions:

- a. The subject amendment to the City Map shall take effect on the day following the day on which certified counterparts of Map Nos. Z-2742 and X-2747 dated May 31, 2016 are filed with the appropriate agencies in accordance with Section 198



subsection c of the New York City Charter and Section 5-435 of the New York City Administrative Code; and

- b. The subject streets to be discontinued and closed shall be discontinued and closed on the day following the day on which such maps adopted by this resolution shall be filed in the offices specified by law.

The above resolution (C 120120 MMK), duly adopted by the City Planning Commission on November 30, 2016 (Calendar No. 2), is filed with the Office of the Speaker, City Council, and the Borough President in accordance with the requirements of Section 197-d of the New York City Charter.

**CARL WEISBROD, Chairman**

**KENNETH J. KNUCKLES, Esq., Vice-Chairman**

**RAYANN BESSER, IRWIN G. CANTOR, P.E. ALFRED C. CERULLO, III,**

**MICHELLE R. DE LA UZ, JOSEPH I. DOUEK, RICHARD W. EADDY,**

**CHERYL COHEN EFFRON, HOPE KNIGHT, ANNA HAYES LEVIN,**

**ORLANDO MARIN, LARISA ORTIZ, Commissioners**

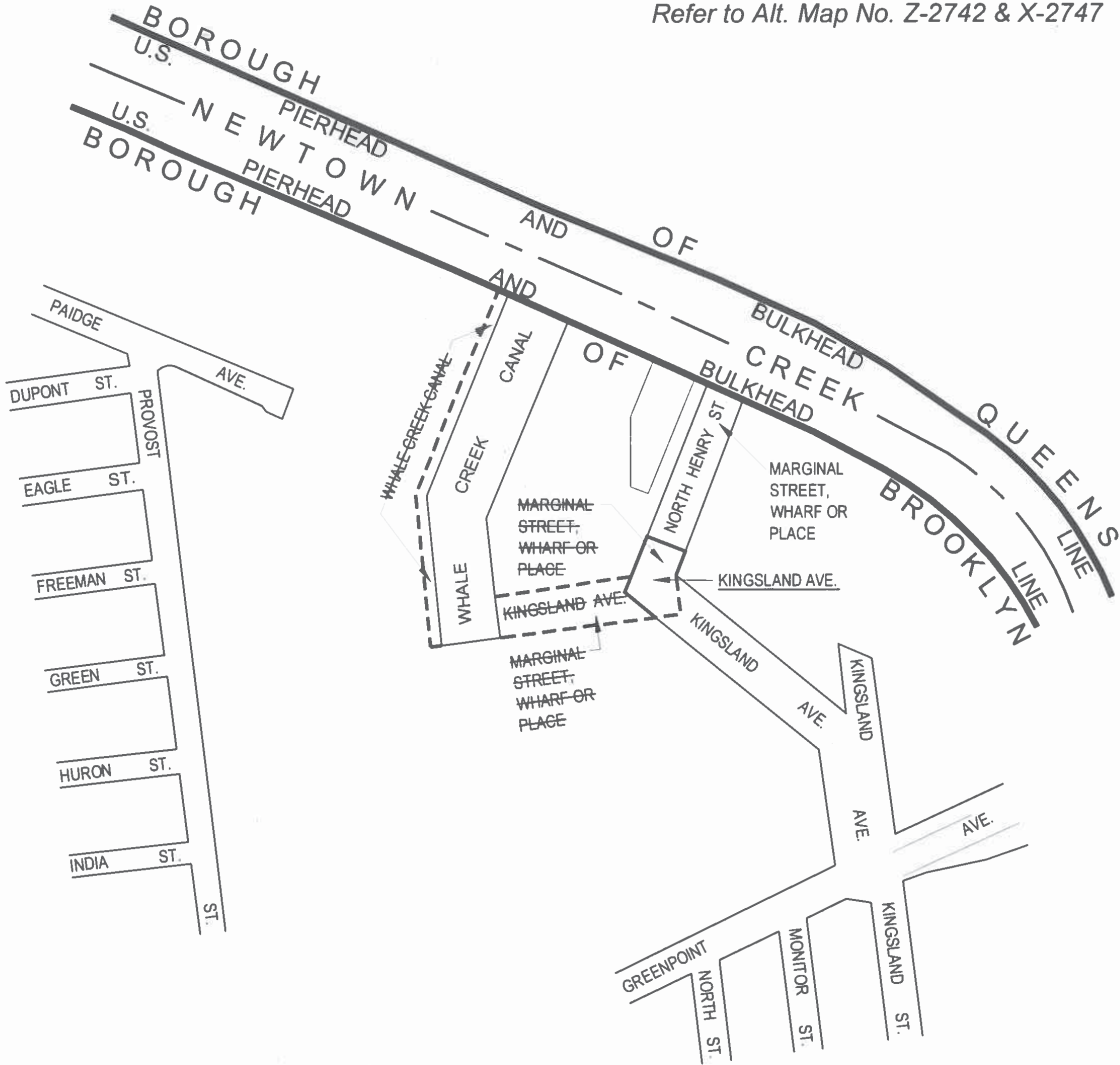

CITY PLANNING COMMISSION  
CITY OF NEW YORK  
DIAGRAM SHOWING PROPOSED  
**MAP CHANGE**  
ON SECTIONAL MAP

**13**

BOROUGH OF  
**BROOKLYN**

New York, Certification Date  
JULY 11, 2016

*Jamie Hingston*  
on behalf of the  
Chief Engineer



- NOTE:**
- Indicates line of street legally adopted.
  - Indicates line of street proposed to be established.
  - - - Indicates line of street proposed to be eliminated.  
(Discontinuance and Closing is shown on Alt. Map No. X-2747).







# COMMUNITY BOARD No. 1

435 GRAHAM AVENUE - BROOKLYN, NY 11211-1451

PHONE: (718) 389-0009

FAX: (718) 389-0098

Email: [bk01@cb.nyc.gov](mailto:bk01@cb.nyc.gov)

Website: [www.nyc.gov/brooklyn1](http://www.nyc.gov/brooklyn1)

HON. ERIC L. ADAMS  
BROOKLYN BOROUGH PRESIDENT



RABBI ABRAHAM PERLSTEIN  
FIRST VICE-CHAIRMAN

DEL TEAGUE  
SECOND VICE-CHAIRPERSON

STEPHEN J. WEIDBERG  
THIRD VICE-CHAIRMAN

MARIA VIERA  
FINANCIAL SECRETARY

ALMA SAVOIA  
RECORDING SECRETARY

PHILIP A. CAPONEGRO  
MEMBER-AT-LARGE

DEALICE FULLER  
CHAIRPERSON

GERALD A. ESPOSITO  
DISTRICT MANAGER

HON. STEPHEN T. LEVIN  
COUNCILMEMBER, 33rd CD

HON. ANTONIO REYNOSO  
COUNCILMEMBER, 34th CD

Revised  
September 14, 2016

## LAND USE, ULURP & LANDMARKS (subcommittee) COMMITTEE REPORT

TO: Chairperson Dealice Fuller and CB #1 Board Members

FROM: Ms. Del Teague, Committee Chair  
Ms. Alma Savoia, Committee Co-Chair  
Ms. Trina McKeever, Landmarks Subcommittee Chair

RE: Land Use Committee Meeting Held on September 8, 2016  
(9 Members Constitute a Quorum For This Committee)

The Land Use, ULURP & Landmarks (subcommittee) Committee met on Thursday, September 8, 2016 at 6:00 PM, in the CB #1's District Office, 435 Graham Avenue, Brooklyn, NY 11211.

**ATTENDANCE:** Present – Teague; Savoia; McKeever; Barros; Rabbi Niederman; Rabbi Perlstein; Viera; Weidberg; Weiser. Absent – Argento; Dybanowski; Franczoz; Hoffman; McCann; Neustein; Sofer, Solano.

### (1.) **AGENDA:** PFIZER SITES REZONING DRAFT SCOPE OF WORK FOR AN ENVIRONMENTAL IMPACT STATEMENT (E.I.S.) CEQR No. 15DCP117K ULURP No. N150277ZRK & 1502787ZMK

The committee met to prepare the draft for the board's response to the city's EIS scoping document. The committee reviewed the comments provided by board members. Fortunately, all board members who submitted responses were in attendance, so we were able to include those individuals in the preparation of the attached document. All modifications to the submitted statements were done with the consent of the board members who had made the submissions.

**Recommendation:** We were one member short of a quorum. The attached document was approved by all committee members present, as well as those board members who had submitted

written responses.

Please note, the “no comment” responses do not indicate a lack of concern by the board with respect to the related headings. This response simply indicates that we have not found a need to expand on the already rather extensive analysis required by the city.

We will have an opportunity to comment further during the ULURP process.

---

**(2.) NYC DEP PROPOSAL - to extend the existing Newtown Creek Nature Walk to Connect To Public Kingsland Avenue. #C 120120 MMK- IN THE MATTER OF** an application submitted by the NYC Dept. of Environmental Protection and the New York City Department of Small Businesses pursuant to Section 197-c and 199 of the NYC Charter, and Section 5-430 *et seq.* of the NYC Administrative Code for an amendment of the City Map involving:

- the elimination, discontinuance and closing of a portion of marginal street, wharf or place east of Whale Creek Canal;
- the establishment of a cul-de-sac to Kingsland Avenue north of Greenpoint Avenue;
- the narrowing of Whale Creek; and
- the adjustment of grades and block dimensions necessitated thereby;

Including authorization for any acquisition or disposition of real property related thereto; in the Borough of Brooklyn, Community District 1, in accordance with Map Nos. Z-2742 and X-2747 dated May 31, 2016 and signed by the Borough President.

**#C 160243PSK – IN THE MATTER OF** an application submitted by the Department of Environmental Protection, the Department of Small Business Services, and the Department of Citywide Administrative Services, pursuant to Section 197-c of the NYC Charter, for the site selection of a portion of the marginal street, wharf or place located between the Whale Creek Canal and Kingsland Avenue for use as a nature walk.

**Recommendation:** The committee recommended that the board request clarification of the plans for lighting the entire area around the nature walk and what provisions will be installed for trash disposal.

The committee also supported adding the additional requests that there be open communication with the businesses by Kingsland Avenue, and that attention be focused on safety measures for cyclists and pedestrians.

---

**PFIZER SITES REZONING  
DRAFT SCOPE OF WORK FOR AN ENVIRONMENTAL IMPACT STATEMENT  
(E.I.S.) CEQR No. 15DCP117K, ULURP No. N150277ZRK & 1502787ZMK**

<p><b>Task 1. PROJECT DESCRIPTION</b> - No comment.</p>
<p><b>Task 2. LAND USE, ZONING AND PUBLIC POLICY</b> – The subtasks in this task should be more explicit and should include an analysis of the association of this proposed re-zoning with the Broadway Triangle Urban Renewal Area.</p>
<p><b>Task 3. SOCIOECONOMIC CONDITIONS</b> – The analysis should include a study of what steps need to be taken to comply with the Federal Fair Housing Act requirements to reduce/ameliorate the shocking racial separations in the immediate area, specifically that the population of Community District #1 is only about 5% African-American/Black, while the adjoining Community District #3 is between 75-90% African-American/Black, with Flushing Avenue being the effective racial barrier between the two.</p> <p>The analysis should include what impacts the proposed re-zoning will have on commercial/industrial development in the area, particularly in light of the over-occupancy and demand for such space for start-ups, etc. in the Navy Yard building(s).</p> <p>The residential displacement analysis should be expanded to address the impact on the existing Rent Stabilized tenant populations surrounding the proposed re-zoning area.</p>
<p><b>Task 4. COMMUNITY FACILITIES</b></p> <ul style="list-style-type: none"> <li>- <b>Public Schools</b> - The analysis should include the impact that the re-zoning would have on the high schools in Community Boards #1 and #3.</li> <li>- <b>Libraries</b> – no comment.</li> <li>- <b>Child Care Centers</b> – The analysis should include a disclosure of the lease terms for the day care facilities in the area, and whether we are at risk of losing leases beyond the 2019 EIS cut-off date.</li> </ul>
<p><b>Task 5. OPEN SPACE</b> – The open space areas/provisions have not been defined. However, at such time as they are defined, the developer should have to address the plan for the upkeep, supervision, and enforcement of public safety measures.</p>

<p><b>Task 6. SHADOWS</b> -- no comment.</p>
<p><b>Task 7. HISTORIC AND CULTRAL RESOURCES</b></p> <ul style="list-style-type: none"> <li>- <b>Architectural Resources</b> – no comment.</li> <li>- <b>Archaeological Resources</b> – no comment.</li> </ul>
<p><b>Task 8. URBAN DESIGN AND VISUAL REOURCES</b> – no comment.</p>
<p><b>Task 9. HAZARDOUS MATERIALS</b> – no comment.</p>
<p><b>Task 10. WATER AND SEWER INFRASTRUCTURE</b></p> <ul style="list-style-type: none"> <li>- <b>Water Supply</b> – no comment.</li> <li>- <b>Wastewater and Stormwater Infrastructure</b> – no comment.</li> </ul>
<p><b>Task 11. ENERGY</b> – no comment.</p>
<p><b>Task 12. TRANSPORTATION</b> – The analysis should take into consideration the ongoing transportation studies for the entire area.</p> <p>Given limited access to the G train at the Flushing Avenue stop, the analysis should describe the station elements of that location, including street stairs and fare control areas.</p> <p>With respect to the JMZ lines, the 2019 analysis should take into account the proposed closure of the L train.</p> <p>In light of the diversity of religions observed in the area, the traffic studies should include Sundays in addition to Saturdays.</p>
<p><b>Task 13. AIR QUALITY</b> – no comment.</p>
<p><b>Task 14. GREENHOUSE GAS EMISSIONS AND CLIMATE CHANGE</b> – no comment.</p>



<b>Task 15. NOISE -- no comment.</b>
<b>Task 16. PUBLIC HEALTH – no comment.</b>
<b>Task 17. NEIGHBORHOOD CHARACTER – no comment.</b>
<b>Task 18. CONSTRUCTION -- no comment.</b>
<b>Task 19. MITIGATION – no comment.</b>
<b>Task 20. ALTERNATIVES – no comment.</b>
<b>Task 21. SUMMARY EIS CHAPTERS – no comment.</b>
<b>Task 22. EXECUTIVE SUMMARY – no comment.</b>



### Email/Fax Transmittal

<b>TO:</b> Community District 1 Distribution	<b>FROM:</b> Brooklyn Borough President Eric L. Adams
<b>DATE: October 19, 2016</b>	<b>CONTACT:</b> Olga Chernomorets – Land Use Coordinator Phone: (718) 802-3751 Email: ochernomorets@brooklynbp.nyc.gov
<b>ULURP Recommendation:</b> NEWTOWN CREEK NATURE WALK PHASE III – 160243 PSK and 120120 MMK	<b>NO. Pages, Including Cover: 10</b>

Attached is the recommendation report for ULURP applications 160243 PSK and 120120 MMK. If you have any questions, please contact Olga Chernomorets at (718) 802-3751.

#### Distribution

NAME	TITLE	OFFICE	EMAIL
<b>Carl Weisbrod</b>	Chair, City Planning Commission	(212) 720-3356	ygruel@planning.nyc.gov
<b>Honorable Melissa Mark-Viverito</b>	Speaker, New York City Council	(212) 788-7207	mviverito@council.nyc.gov
<b>Winston Von Engel</b>	Director, Brooklyn, Department of City Planning (DCP)	(718) 780-8280	wvoneng@planning.nyc.gov
<b>Jackie Harris</b>	Director, Land Use Review, DCP	(212) 720-3356	jharris@planning.nyc.gov
<b>Raju Mann</b>	Director, Land Use Division, New York City Council	(212) 788-7207	rmann@council.nyc.gov
<b>Amy Levitan</b>	Land Use Division, New York City Council	(212) 788-7207	alevitan@council.nyc.gov
<b>Stephen Levin</b>	Council Member, District 34	(718) 875-5200	slevin@council.nyc.gov
<b>Dealice Fuller</b>	Chair, Community Board 1 (CB 1)	(718) 389-0098	bk01@cb.nyc.gov
<b>Gerald A. Esposito</b>	District Manager, CB 1	(718) 389-0098	bk01@cb.nyc.gov
<b>Randal Fong</b>	Assistant Commissioner, Department of Citywide Administration (DCAS)	(212) 386-0618	rfong@dcas.nyc.gov
<b>Ken Moriarty</b>	Acting Assistant Commissioner, Department of Environmental Protection (DEP)	(718) 595-6238	kmoriarty@dep.nyc.gov
<b>Alicia West</b>	Director, Public Design Outreach, DEP	(718) 595-5673	awest@dep.nyc.gov
<b>Richard Bearak</b>	Director, Land Use, BBPO	(718) 802-4057	rbearak@brooklynbp.nyc.gov

**Brooklyn Borough President Recommendation**

CITY PLANNING COMMISSION  
22 Reade Street, New York, NY 10007  
CalendarOffice@planning.nyc.gov



**INSTRUCTIONS**

1. Return this completed form with any attachments to the Calendar Information Office, City Planning Commission, Room 2E at the above address.
2. Send one copy with any attachments to the applicant's representatives as indicated on the Notice of Certification.

**APPLICATION**

NEWTOWN CREEK NATURE WALK PHASE III – 160243 PSK and 120120 MMK

In the matter of the applications, submitted by the New York City Department of Environmental Protection (DEP), the New York City Department of Small Business Services (SBS), and the New York City Department of Citywide Administrative Services (DCAS), pursuant to Section 197-c of the New York City Charter, for the site selection of a portion of the marginal street located between the Whale Creek Canal and Kingsland Avenue, within the Greenpoint section of Community District 1 (CD 1) for use as a Nature Walk. Additionally, DEP and SBS seek authorization pursuant to Section 197-c and 199 of the New York City Charter and Section 5-430 *et seq.* of the New York City Administrative Code for an amendment to the City Map involving: the elimination, discontinuance, and closing of a portion of marginal street east of Whale Creek Canal; the establishment of a cul-de-sac in Kingsland Avenue north of Greenpoint Avenue; the narrowing of Whale Creek Canal, and the adjustment of block dimensions and grades necessitated thereby.

COMMUNITY DISTRICT NO. 1

BOROUGH OF BROOKLYN

**RECOMMENDATION**

APPROVE  
 APPROVE WITH  
MODIFICATIONS/CONDITIONS

DISAPPROVE  
 DISAPPROVE WITH  
MODIFICATIONS/CONDITIONS

SEE ATTACHED

\_\_\_\_\_  
BROOKLYN BOROUGH PRESIDENT

October 14, 2016

\_\_\_\_\_  
DATE

**RECOMMENDATION FOR: NEWTOWN CREEK NATURE WALK PHASE III – 160243 PSK and 120120 MMK**

Applications submitted by the New York City Department of Environmental Protection (DEP), the New York City Department of Small Business Services (SBS), and the New York City Department of Citywide Administrative Services (DCAS), pursuant to Section 197-c of the New York City Charter, seek authorization for the site selection of a portion of the marginal street located between the Whale Creek Canal and Kingsland Avenue, within the Greenpoint section of Community District 1 (CD 1) for use as a Nature Walk. Additionally, DEP and SBS seek authorization pursuant to Section 197-c and 199 of the New York City Charter and Section 5-430 *et seq.* of the New York City Administrative Code for an amendment to the City Map involving: the elimination, discontinuance, and closing of a portion of marginal street east of Whale Creek Canal; the establishment of a cul-de-sac in Kingsland Avenue north of Greenpoint Avenue; the narrowing of Whale Creek Canal, and the adjustment of block dimensions and grades necessitated thereby. Such actions will allow the expansion of Newtown Creek Nature Walk by enabling the completion of Phase III of the project.

On September 26, 2016, Brooklyn Borough President Eric L. Adams held a public hearing on the site selection and City Map amendment. There were no speakers on this item.

In response to Borough President Adams noting the lack of lighting depicted on the provided site plans and seeking clarification on the hours of operation, the DEP representative stated that there will be lighting throughout Phase II, which will match the lighting fixtures within the existing Phase I of the Nature Walk. Such lighting fixtures will include accent lighting, cylindrical lighting poles, in-ground lighting, lights integrated into the fence and light poles along some of the linear elements of the Nature Walk. The representative confirmed that the lighting does not disrupt any industrial activities taking place on the water. The Nature Walk's hours of operation are dawn to dusk, modelled after the New York City Department of Parks and Recreation regulations.

In response to Borough President Adams' observation of the absence of trash receptacles being depicted on the provided site plans, the DEP representative stated that trash receptacles will be provided throughout Phase III. The receptacles are designed to look like barrels as a reference to the coopeage trade along the Newtown Creek.

In response to Borough President Adams' concern with regard to pedestrian safety, given the isolated location of the Nature Walk, the DEP representative stated that a call box was provided at the Phase I entrance because, when first constructed, it dead-ended. Since there would no longer be a dead-end condition with the expansion of the Nature Walk, DEP was not intending to provide an additional call box at the entrance of Phase III, with the original call box remaining active. However, this does not preclude future provision of a call box at the entrance of Phase III if it is deemed necessary.

In response to Borough President Adams' policy promoting practices to retain stormwater runoff by including bioswales at the tree pits in the entrance plaza to Phase III, the DEP representative stated that there were limitations in the amount of softscaping that could be achieved at the entrance plaza. The representative stated that DEP was constrained by the New York City Department of City Planning's (DCP) circulation and clearance requirements. DEP has been in communication with the area's industrial business advocate agency, Evergreen, to obtain assistance in understanding some goals for Kingsland Avenue businesses.

In response to Borough President Adams' interest in introducing a bike lane along Kingsland Avenue, which would connect the existing bike lane along Greenpoint Avenue to the entrance of Phase III, the representative stated that there has already been discussion with Evergreen and New York City Department of Transportation (DOT) regarding organizing such efforts. The

representative stated that from their conversations it does seem that the businesses in the surrounding area are interested in being provided with a bike lane.

In response to Borough President Adams' policy to maximize job opportunities for Brooklynites and procurement of supplies locally, the DEP representative stated that the New York City Department of Design and Construction (DDC) is managing this contract on DEP's behalf. The representative stated that there is a set goal of 18 percent Minority- and Women-Owned Business Enterprises (MWBE) and as well as Local Business Enterprises (LBE) participation for carpentry, electrical, and steel.

Subsequent to the hearing, DEP provided a letter dated October 6, 2016 with clarification in regard to some of the questions discussed at the hearing. With respect to Borough President Adams' stormwater runoff policies, DEP stated that Phase III is designed to infiltrate all stormwater runoff on site by employing swales, rain gardens, and planted areas to absorb water, as well as stabilized gravel, which is permeable. The entrance plaza will have four trees in open tree pits and a generous planting bed that continues into the Nature Walk. DEP worked closely with DCP to establish an entrance plaza design with a nice balance of amenities, such as seating, bike parking, and planting, while also providing the necessary 12-foot-wide flexible circulation path. This flexible circulation space will allow for visitors to gather – whether for walking tours or simply waiting to be picked up by a car – without causing congestion.

In regard to Borough President Adams' policy to maximize job opportunities, DEP stated that DDC is managing this contract on DEP's behalf, and both agencies are committed to using MWBE firms wherever possible. The citywide goals recommended by Local Law 1 are adjusted based on the scope of work for a contract, the availability of MWBEs with the capacity to perform specific types, and the scale of work to be procured. Based on these criteria, DDC has set the participation goal for the Nature Walk contract at 18 percent. For larger or more varied contracts, the participation would be higher. DDC's contractors will also utilize the HireNYC program, as suggested at the hearing.

In regard to Deputy Borough President Diana Reyna's inquiry into potential air quality improvements, DEP stated that they do not expect to see measurable improvement of air quality, as differences are largely driven by changes in local emissions rather than an increase in tree coverage. Additionally, DEP indicated that data collected through any form of monitoring would be difficult to interpret not only because they do not have a baseline to measure against, since Phase I has been in place for nearly a decade, but also because of the number of uncontrolled variables, such as changing weather patterns. However, DEP did suggest that tree coverage can help reduce pollution indirectly by providing shade to help cool neighborhoods, thereby reducing the need for electricity demands on hot days, which in turn reduces emissions.

### **Consideration**

Community Board 1 (CB 1) approved these applications with conditions, requesting: clarification regarding the provision of lighting fixtures and trash receptacles; that agencies maintain open communication with the businesses on Kingsland Avenue, and prioritization of safety measures for cyclists and pedestrians.

In 1996, the 11<sup>th</sup> modification of the City Council resolution for the upgrade of the Newtown Creek Wastewater Treatment Plant (WWTP) directed DEP to provide a landscaped planting strip along the perimeter of the WWTP site. This landscaped strip, the Nature Walk, was part of the process undertaken to respond to the City's law requiring a Percent-for-Art component for any construction done on City property. Additionally, this type of accessory use to a wastewater treatment plant contributes toward implementing the City's Waterfront Revitalization Plan (WRP) policy to preserve

and develop waterfront open space and recreation on publicly-owned land at suitable locations, as well as contributing toward the implementation of other WRP policies.

The Phase I of the Newtown Creek Nature Walk is a land-based waterfront Nature Walk, which starts at Paidge Avenue and follows the Newtown Creek WWTP northern perimeter to Newtown Creek and Whale Creek Canal. Phase I was completed at a cost of \$3.2 million in 2007.

The Phase II portion of the proposed Nature Walk extension is part of an area that was site selected for use by DEP under a prior ULURP action. It will be a water-based extension of Phase I, connecting the two land-based Phase I and Phase III portions. Phase II will consist of a pier deck built out over Whale Creek Canal along its southern and western bulkheads to connect to the proposed Phase III on Kingsland Avenue. Construction of Phase II is estimated at \$8 million.

The Phase III portion of the proposed Nature Walk extension is a land-based extension that would stretch from the eastern end of Phase II and consist of a green area within a 70-foot-wide portion of the proposed demapped marginal street section of Kingsland Avenue, between North Henry Street and Whale Creek Canal. The construction cost for Phase III is estimated at \$9 million, and both Phases II and III are expected to be completed in 2017.

The general surrounding area consists primarily of industrial and manufacturing uses, east and south of the project site, with the WWTP immediately to the south and west. The nearest concentration of residential buildings is mostly located west of McGuinness Boulevard or south of Norman Avenue. Uses immediately adjacent to the site include the Newtown Creek WWTP North and Central Battery process tanks, fewer than 10 feet in height, and part of the WWTP Central Residuals Building, which is four stories in height and is located directly north of Phase III. The New York City Department of Sanitation (DSNY) warehouse and former DSNY Marine Transfer Station building are located just north of the site.

The subject portion of Kingsland Avenue to be demapped has a width of 100 feet north to south and extends from North Henry Street westerly to Whale Creek Canal for approximately 360 feet along its northern boundary line and 430 feet along its southern boundary line. The southern 70-foot-wide north to south portion, totaling approximately 29,000 square feet of the demapped Kingsland Avenue, would be transferred to the DEP and developed by the DEP for Phase III of the Newtown Creek Nature Walk extension. The northern 30-foot-wide portion would be transferred to DSNY, with shared access provided to the DEP through a previously signed Memorandum of Understanding (MOU) between these two agencies.

The section of Kingsland Avenue to remain contains on-street parking for more than 50 vehicles along the westerly portion of Kingsland Avenue, which is separated by a jersey barrier from two-way traffic along the remaining right-of-way. This parking area was previously used by DSNY garbage trucks lining up to discharge solid waste refuse at the Marine Transfer Station.

Following the proposed demapping of Kingsland Avenue and jurisdiction transfer of the southern section of Kingsland Avenue west of North Henry Street to DEP according to the site selection action, construction would proceed on the third and final phase of the Newtown Creek Nature Walk. Construction services will be provided by the New York City Department of Design and Construction (DDC) on behalf of DEP. DEP has been using this section of Kingsland Avenue for assisting with the construction of the adjacent Central Residuals Building. Completion of the Nature Walk would provide a continuous pedestrian link around the Newtown Creek WWTP.

Phase III will consist of a variety of planted and stone-paved areas, seating, tables, and features that would encourage quiet recreation and enjoyment of the waterfront. At the Kingsland Avenue entrance, the site comprises a 50-foot-wide by approximately 10- to 50-foot-wide

sidewalk/plaza area that will include bicycle racks, stone bench seating, street trees, and a trash receptacle. A large boulder will mark the entrance to Phase III of the Nature Walk, as it does at the corner of Provost Street and Paidge Avenue at the entrance to Phase I of the Nature Walk.

From this boulder, a narrow trail of blue granite will lead from the Kingsland Avenue entrance to the waterfront at Whale Creek Canal. The trail will form the spine of Phase III and would be level with the surrounding paving at the entrance, gradually deepening to form a shallow swale, which will collect water and convey it to the rain garden in the western portion of Phase III.

Plant beds will line the central trail, with grasses, perennials, shrubs, and trees. The surrounding paved areas will drain toward these planted areas, which will allow stormwater to seep into the ground. Planting will be predominantly native species, adapted to urban and waterfront conditions.

A shelter would be located close to the center of the Phase III area. To the west of the shelter, a stone paved area will feature five tree fossils set among five Ginkgo trees. The fossils, approximately three feet in diameter, were unearthed during excavation by DEP at the Schoharie Reservoir site in upstate New York. These fossils are more than 380 million years old and provide a link between ancient and recent history, making a wider connection to civilization that will be described by the signage similar to that used to explain local and natural history in the existing Phase I of the Nature Walk.

At the waterfront area, the granite trail will drain into a planted rain garden with wetland plantings. A small pedestrian-scale bridge will provide an overlook to the water. Granite block paving would provide a surface suitable for the vehicular access required by DEP across the area of Phase III.

The waterfront area will also include seating, trees, and an access area at the water's edge similar to that which is in place within the existing Phase I. Another shelter, in the form of a boat shell, with a picnic table, will be located close to the water's edge. Lighting will be provided within both shelters as well as the water's edge, matching the existing light fixtures in Phase I of the Nature Walk. The Phase III area will be bounded by steel fencing 10 feet in height at its eastern and southern edges, and by a solid concrete wall 10 feet in height at the northern edge.

It is Borough President Adams' policy to promote a resilient and sustainable Brooklyn, and he believes that maximum consideration should be given to diverting stormwater runoff from the WWTP. Phase III of the Nature Walk has multiple stormwater runoff management design features. Such features seem largely absent from the Kingsland Avenue cul-de-sac entry plaza as much of that surface is delineated by paved sidewalk, with the exception of a few trees to be placed in minimally-sized tree pits. DEP provided clarification in a letter dated October 6, 2016, stating that they will transform what is currently an entirely impermeable site to one where 93 percent of the project area would contribute to stormwater recapture. The remaining seven percent of impermeable pavement will entail the entrance plaza and will be sloped southeast toward the six-inch curb where DEP's design intervention meets the existing grade of Kingsland Avenue. Borough President Adams applauds DEP's efforts to manage stormwater runoff. He also believes there is an opportunity to modify the plaza design, even further, to incorporate functioning bioswales as part of the proposed tree pits.

Borough President Adams supports the expansion and completion of the Newtown Creek Nature Walk. The Nature Walk is a critical public waterfront amenity for the Greenpoint community, as well as an educational resource. Furthermore, its completion would enhance public safety through the removal of the current dead-end condition.

### **Introduction of a Call Box for the Kingsland Avenue Entrance**

Due to the isolated nature of this area, Phase I of the Nature Walk includes an emergency call box at its entrance. As explained by DEP, Phase I originally dead-ended, a condition that posed safety concerns and made the call box necessary. However, with the expansion of the Nature Walk, as there would no longer be a dead-end condition, DEP determined that an additional emergency call box at the entrance to Phase III would not be necessary.

As the streets leading to the Nature Walk are isolated from pedestrian and vehicular traffic, Borough President Adams believes that the local police precinct should determine whether there should be an additional emergency call box at the entrance of Phase III. In response, the Office of Brooklyn Borough President contacted the 94<sup>th</sup> Precinct of the New York City Police Department (NYPD), who confirmed that public safety consideration warrants the installation of an emergency call box as part of the Phase III improvement.

Borough President Adams urges DEP to coordinate with NYPD to determine where an emergency call box should be incorporated in proximity to the Kingsland Avenue entrance plaza of the Nature Walk. DEP should also include the emergency call box within its design and construction documents.

### **Introduction of a Bike Lane Along Kingsland Avenue**

Borough President Adams is a supporter of Mayor de Blasio's Vision Zero strategy. One component of Vision Zero is to design new streets and redesign existing streets to safely accommodate all modes of transportation. It is important to consider how bicyclists, motorists, and pedestrians interact when developing such street designs and policies. Introducing protected or buffered bike lanes as traffic calming and separation mechanisms creates a safer experience for everyone. It is among Borough President Adams' policies to support DOT's efforts to create and connect bike routes where appropriate throughout the borough to provide safer streets for bicyclists, motorists, and pedestrians.

Borough President Adams believes that bike lanes promote a more orderly flow of traffic by helping define road space, creating a visual reminder to drivers to look for bicyclists, provide an added buffer for pedestrians between sidewalks and traffic, and acting as a "traffic calming" mechanism because roads that appear narrow result in safer vehicular speeds.

The existing Phase I of the Nature Walk is connected to the bike route in the area, along McGuinness Boulevard to Paidge Avenue, where the entrance to Phase I is located. The entrance of Phase III would front the proposed cul-de-sac of Kingsland Avenue. Taking into consideration the safety of bicyclists, motorists, and pedestrians Kingsland Avenue poses several challenging conditions. Between North Henry Street and Greenpoint Avenue, Kingsland Avenue is subdivided by a barrier into two functional streets. The two-way street along the eastern side has one lane provided in each travel direction and is bordered predominantly by industrial use with associated truck traffic. The western side consists of a one-way lane serving parking along both sides of the travel lane. Furthermore, this area is somewhat isolated from public transit.

Borough President Adams believes that the opening of Phase III of the Nature Walk would increase pedestrian and bicycle traffic along this section of Kingsland Avenue. Given the challenging conditions that might pose high safety risks between the Nature Walk's entry plaza and Greenpoint Avenue, he believes that the entrance to Phase III warrants consideration for the incorporation of a bike lane spur connected to the existing bike route at Greenpoint Avenue, along Kingsland Avenue.



DEP should coordinate with DOT, in conjunction with CB 1, Evergreen, and local elected officials, to determine the appropriateness of installing a bike lane along Kingsland Avenue, in order to connect the Greenpoint Avenue bike route to the entrance of Newtown Creek Nature Walk Phase III.

**Recommendation**

Be it resolved that the Brooklyn borough president, pursuant to sections 197-c and 199 of the New York City Charter, and Section 5-430 *et esq.* of the New York City Administrative Code, recommends that the City Planning Commission and City Council approve these applications.

Be it further resolved that:

1. The New York City Department of Environmental Protection (DEP) coordinate with the New York City Police Department (NYPD) to determine whether an emergency call box should be incorporated in proximity to the Kingsland Avenue entry plaza of the Newtown Creek Nature Walk Phase III and should such box be recommended by NYPD, that DEP include the emergency call box within its design and construction documents, and
2. DEP coordinate with New York City Department of Transportation (DOT), in conjunction with Community Board 1 (CB 1), Evergreen, and local elected officials, to determine the appropriateness of installing a bike lane along Kingsland Avenue, in order to connect the Greenpoint Avenue bike route to the entrance of Newtown Creek Nature Walk Phase III



Vincent Sapienza  
Acting Commissioner

Alicia West  
Director  
Public Design Outreach  
Bureau of Public Affairs &  
Communications

59-17 Junction Boulevard  
Flushing, NY 11373

(718) 595-5673  
awest@dep.nyc.gov

October 6, 2016

Deputy Borough President Diana Reyna  
Richard Bearak, Director of Land Use  
Olga Chernomorets, Land Use Coordinator  
Office of the Brooklyn Borough President  
Eric L. Adams  
209 Joralemon Street  
Brooklyn, New York 11201

Dear Deputy Borough President Reyna, Mr. Bearak and Ms. Chernomorets,

Thank you for the opportunity to present the designs for the Phase III of the Waterfront Nature Walk at the public hearing on September 26, 2016. As a follow-up to your outstanding questions, we are pleased to provide the following information.

**Kingsland Avenue Entrance/Stormwater Management:** Phase III is designed to infiltrate all stormwater runoff on site. We are employing swales, rain gardens and planted areas to absorb water, and the stabilized gravel is permeable. At the entrance, we are providing four trees in open tree pits and a generous planting bed that continues into the Nature Walk. We worked with the Department of City Planning to establish an entrance plaza design with a nice balance of amenity (seating and bike parking) and planting while providing a 12' W flexible circulation path. This flexible circulation space will allow for visitors to gather – whether for a walking tour or simply waiting to be picked up by car – without causing the area to get too crowded. I have attached the layout and planting plans for the entrance that illustrate the 12' W circulation path with the amenities and planting.

**MWBE and Local Participation:** DDC is managing this contract on DEP's behalf, and our agencies are committed to using MWBE firms wherever possible. The citywide goals recommended by Local Law 1 are adjusted based on the scope of work for a contract and the availability of MWBEs with the capacity to perform specific types and scale of work to be procured. Based on these criteria, DDC has set the participation goal for the Nature Walk contract at 18%. For larger or more varied contracts, the participation would be higher. DDC's contractors will also utilize the HireNYC program, as suggested by the Borough President's Office.

**Air Quality Improvements:** We do not expect to see measurable improvement of air quality, as differences are largely driven by changes in local emissions rather than an increase in tree coverage. Additionally, the data that any monitoring would collect would be difficult to interpret not only because we do not have a baseline to measure against, since Phase I has been

in place for nearly a decade, but also because of the number of uncontrolled variables, such as changing weather patterns. However, tree coverage can help reduce pollution indirectly by providing shade that helps to cool neighborhoods, thereby reducing the need for electricity demands on hot days, which in turn reduces emissions. We expect the Nature Walk to be an urban oasis and a key waterfront amenity for Greenpoint.

Thank you again for your support as the final phase moves through the process. Please let me know if you have any questions or need additional information.

Sincerely,

A handwritten signature in black ink that reads "Alicia West". The signature is written in a cursive style with a long horizontal flourish extending to the right.

Alicia West